



PORTE E BOCCAPORTI

DOORS AND HATCHES

Porte stagne
Weathertight doors

Porte sottobattente
Watertight doors

Porte al fuoco A30
Fire doors A30

Porte stagne a pantografo
Pantograph weathertight doors

Boccaporti di coperta
Hatches

Portelli verticali
Vertical Hatches

Porte corridoio
Corridor doors

Tambucci
Companion doors

MS
METALSTYLE

HELL

Caratteristiche standard

- Verniciatura a polvere con RAL 9010
- Viteria in acciaio inox
- Maniglia apertura in alluminio centrale
- Cerniere posizionate sul lato destro
- Guarnizioni di tenuta
- 5 spade di serraggio in acciaio inox

Opzioni

- Colore a richiesta
- Rimpimento con isolante acustico
- Cerniere sul lato sinistro
- Controtelaio

Main features

- Powder painted std colour RAL 9010
- Stainless steel bolts
- Aluminium central toggle
- Right side door arrangement
- Gasket
- 5 stainedsteel dogs locking

Options

- Painting on request
- Acoustic insulation
- Side-by-side door arrangement
- Back flange



PORTE STAGNE
WEATHERTIGHT DOORS

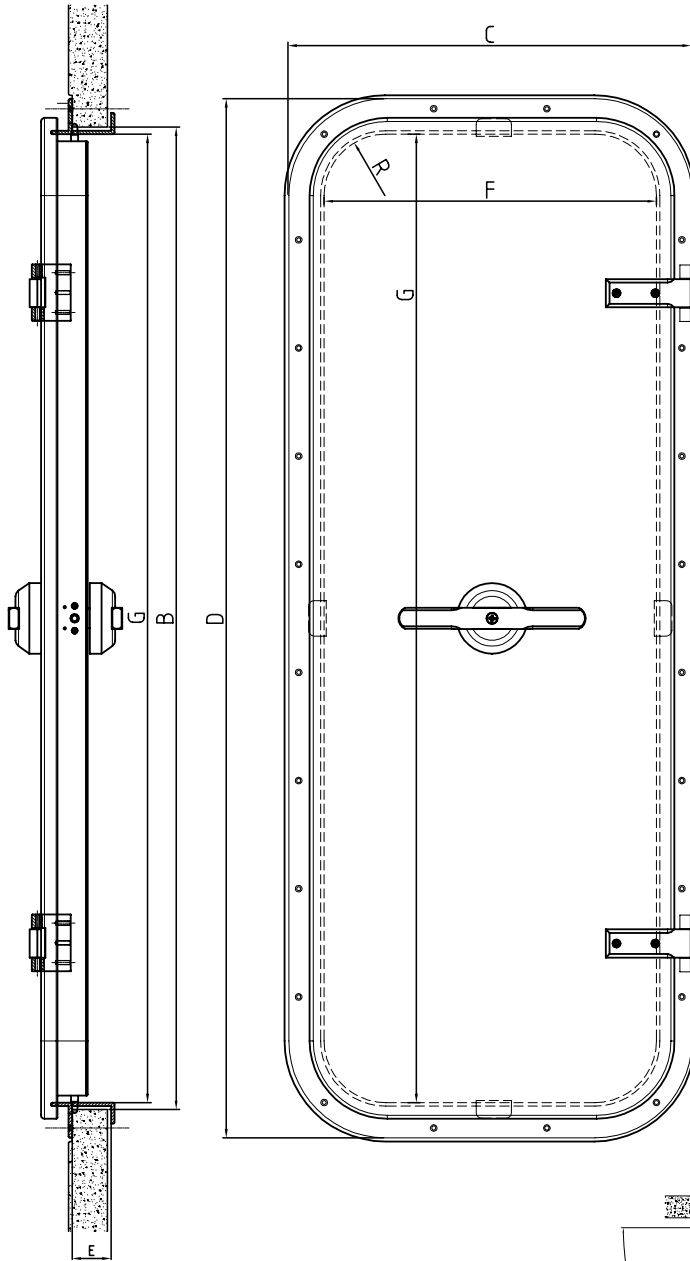

- A : X + 20
- B : Y + 20
- C : X + 100
- D : Y + 100
- F : X Light opening
- G : Y Light opening
- H : 400
- I : 140
- R : 90°

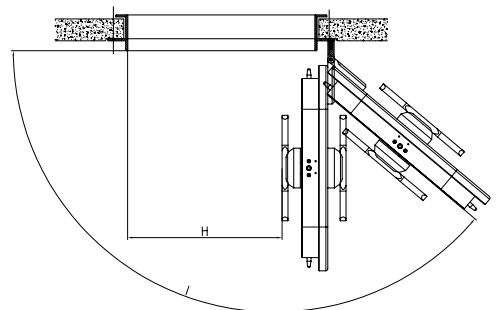
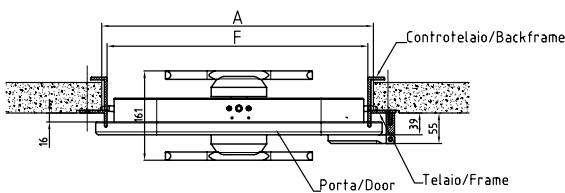

ANGEL

Caratteristiche standard

- Certificazione Type Approval sottobattente 3 mt.
- Telaio in acciaio inox sp 6mm verniciato a polvere RAL 9010 con fori per vite UNI 5732
- Porta in alluminio verniciata a polvere RAL 9010
- 4 Cerniere regolabili in acciaio inox
- Sensore chiuso/aperto
- Viteria cerniere in acciaio inox
- Maniglia di apertura/chiusura in acciaio inox in posizione centrale
- N 8 spade di serraggio in acciaio inox diam 12mm

Opzioni

- Colore a richiesta
- Telaio in acciaio inox lucido
- Telaio con fori di fissaggio svasati per vite UNI 5933
- Chiusura centrale con volantino in acciaio inox
- Inserimento di isolante acustico
- Controflangia in acciaio 304 sp 4mm di fissaggio a paratia lucida o verniciata
- Guarnizione telaio-paratia



Su richiesta: Chiusura centrale con volantino in acciaio inox 316

On request: Central stainless steel wheel

Main features

- Type Approved watertight 3mt certified
- Powder painted std colour RAL 9010 Aisi 316 leaf 6mm with holes for UNI 5732 screws
- Aluminium door powder painted RAL 9010
- 4 Stainless steel Adjustable hinges
- Open/close sensor
- Stainless steel hinge bolts
- SS Aisi 316 central closing system (toggle)
- 8 SS Aisi 316 dogs docking diam 12mm

Options

- Painting on request
- Polished stainless steel Leaf
- Leaf with fixing holes for UNI 5933 screws
- Closing system by means of a central stainless steel wheel
- Acoustic insulation
- Back flange in SS Aisi 304 polished or painted
- Gasket leaf-wall



PORTE SOTTOBATTENTE
WATERTIGHT DOORS



TYPE APPROVAL

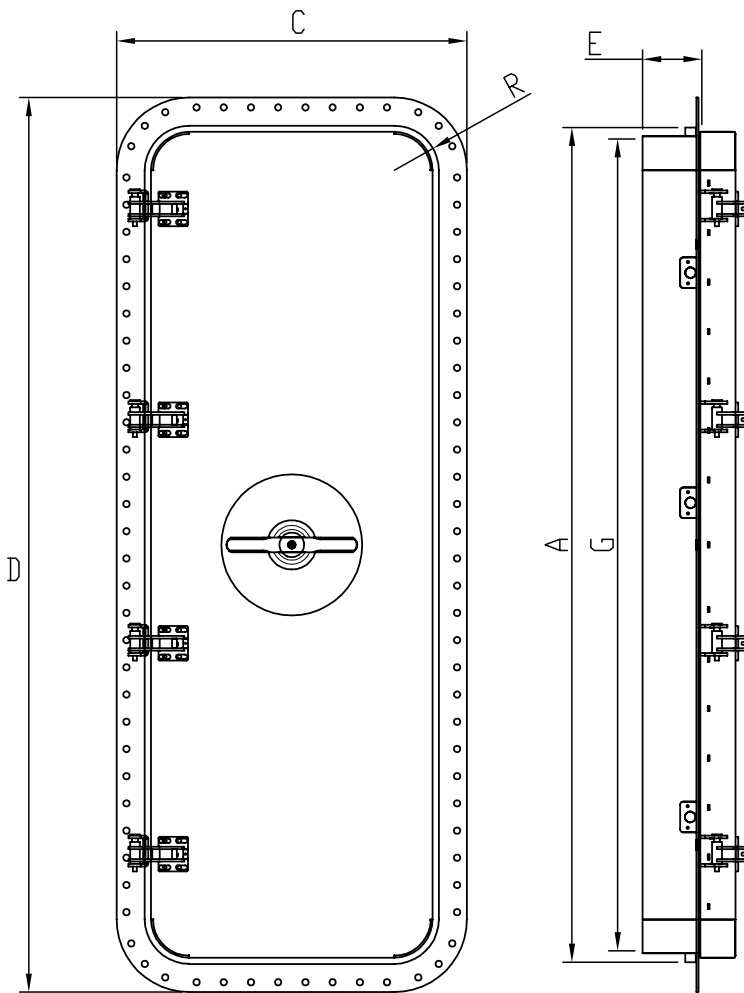

- A : X + 52
- B : Y + 52
- C : X + 172
- D : Y + 172
- E : 120
- F : X Light opening
- G : Y Light opening
- H : X - 80
- I : 140°
- R : 90°

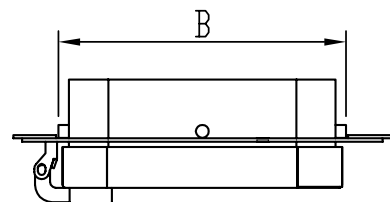
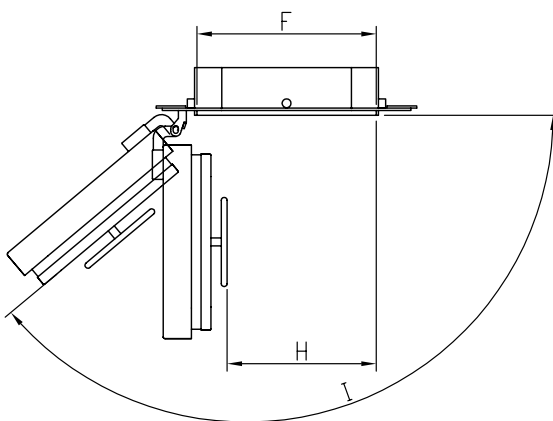

DEMON

Caratteristiche standard

- Certificazione A30 (MED su richiesta) e sottobattente RINA 3 mt.
- Telaio in acciaio inox sp 6mm verniciato a polvere RAL 9010 con fori per viti UNI 5732
- Porta in acciaio Aisi 304 verniciata a polvere RAL 9010
- 4 Cerniere regolabili in acciaio inox
- Sensore chiuso/aperto
- Viteria cerniere in acciaio inox
- Maniglia di apertura/chiusura in acciaio inox in posizione centrale
- N 8 spade di serraggio in acciaio inox diam 12mm

Opzioni

- Colore a richiesta
- Telaio in acciaio inox lucido
- Telaio con fori di fissaggio svasati per viti UNI 5933
- Chiusura centrale con volantino in acciaio inox
- Controflangia in acciaio 304 sp 4mm di fissaggio a paratia lucida o verniciata
- Guarnizione telaio-paratia

Main features

- A30 certified and watertight 3mt RINA (MED certificate upon request)
- Powder painted std colour RAL 9010 Aisi 316 leaf 6mm with holes for UNI 5732 screws
- SS Aisi 304 door powder painted RAL 9010
- 4 Stainless steel Adjustable hinges
- Open/close sensor
- Stainless steel hinge bolts
- SS Aisi 316 central closing system (toggle)
- 8 SS Aisi 316 dogs docking diam 12mm

Options

- Painting on request
- Polished stainless steel Leaf
- Leaf with fixing holes for UNI 5933 screws
- Closing system by means of a central stainless steel wheel
- Back flange in SS Aisi 304 polished or painted
- Gasket leaf-wall



4 cerniere regolabili
in acciaio inox 316
4 stainless steel
adjustable hinges



8 spade in acciaio inox 316
8 stainless steel Aisi 316 dogs

PORTE AL FUOCO A30
FIRE DOORS A30



Certificato **MED** su richiesta
MED Certificate upon request

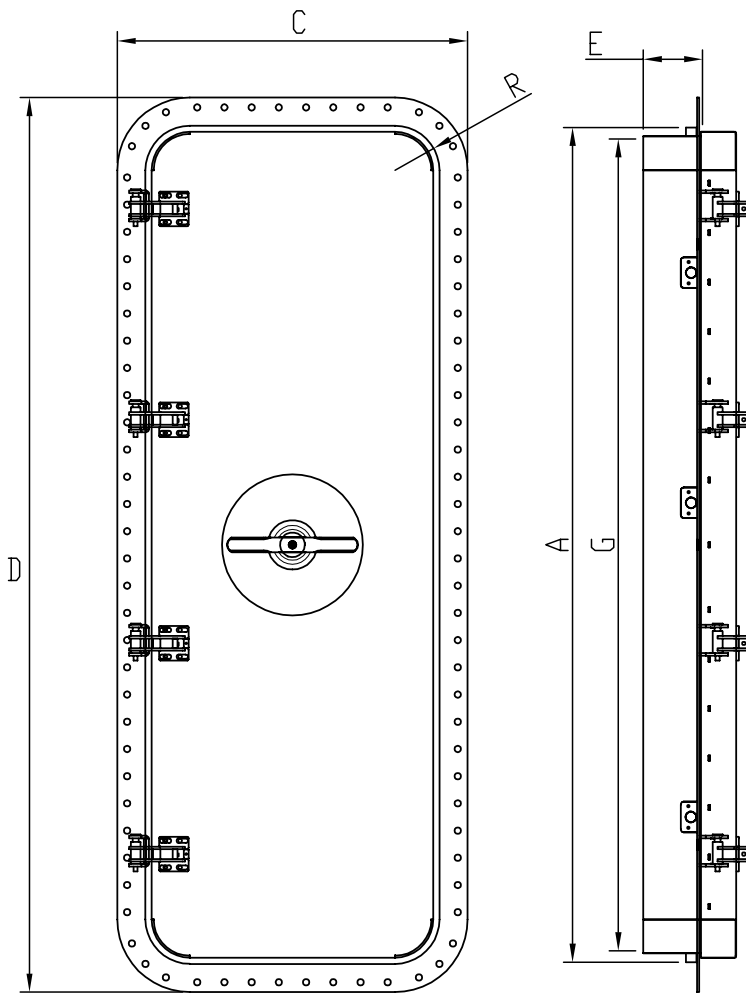

- A : X + 52
- B : Y + 52
- C : X + 172
- D : Y + 172
- E : 120
- F : X Light opening
- G : Y Light opening
- H : X - 80
- I : 140°
- R : 90°

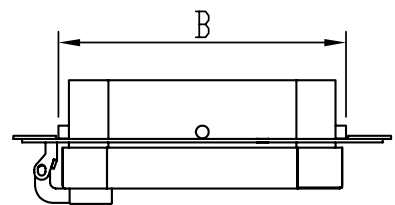
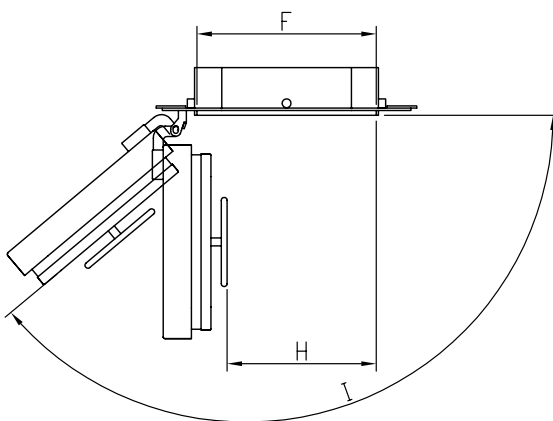

PORTE STAGNE A PANTOGRAFO
PANTOGRAPH WEATERTIGHT DOORS

WING



PORTE STAGNE A PANTOGRAFO
PANTOGRAPH WEATERTIGHT DOORS

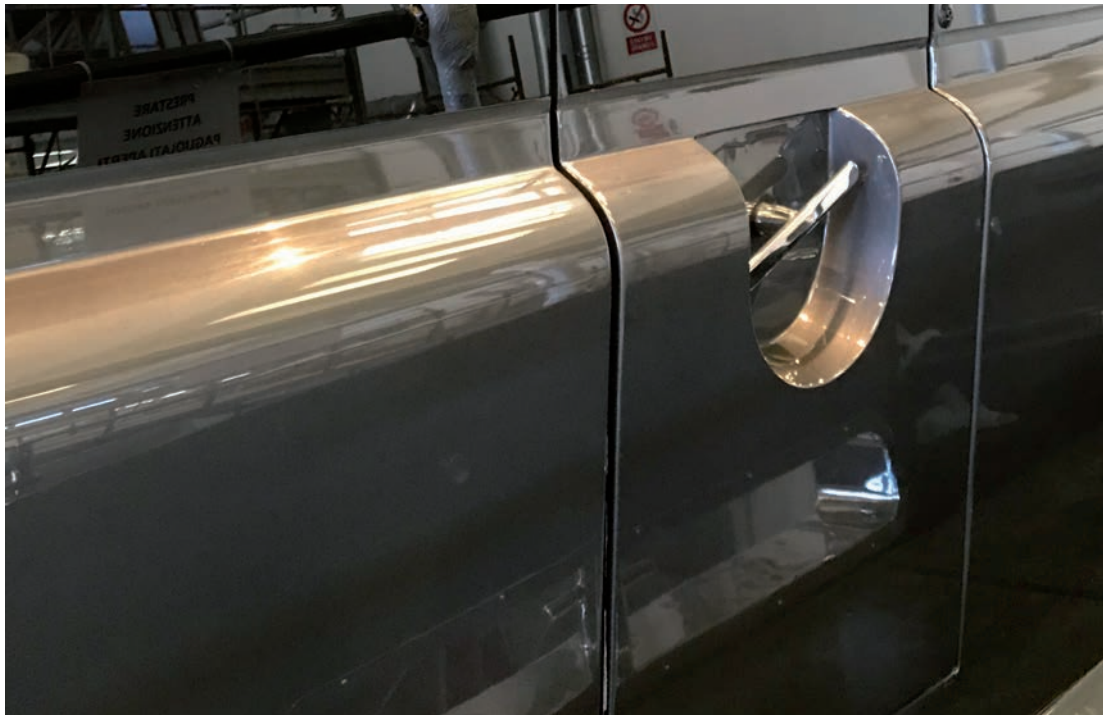

DUCK



Caratteristiche standard

- Telaio in alluminio (Type approval) o acciaio inox (A30)
- Movimentazione con n 2 colli d'oca in acciaio inox
- Sensore chiuso/aperto
- Chiusura esterna in acciaio inox
- Maniglia interna in acciaio inox
- 5 spade di serraggio in acciaio inox diam 16

Opzioni

- Telaio verniciato con colore a richiesta
- Chiusura esterna con chiave
- Volantino interno in acciaio inox

Main features

- Unpainted aluminum (Type approved) or stainless steel (A30) frame
- Movement by means of n 2 stainless steel systems
- Open/close sensor
- External stainless steel closing system
- Internal stainless steel central toggle
- 5 stainless steel dogs diam 16 mm

Options

- Frame painted in color on request
- External security key closing system
- Internal stainless steel wheel



TYPE APPROVAL
A30

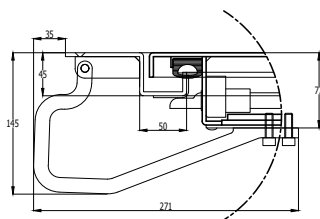
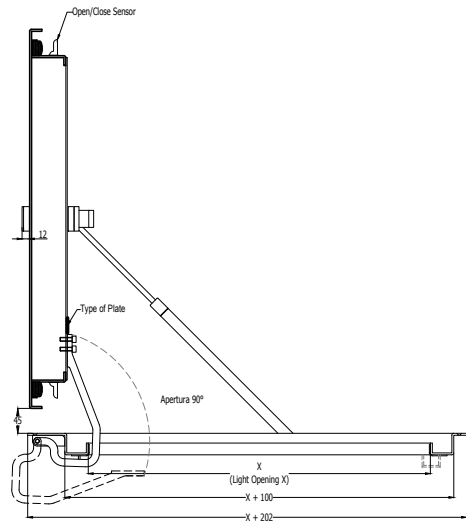
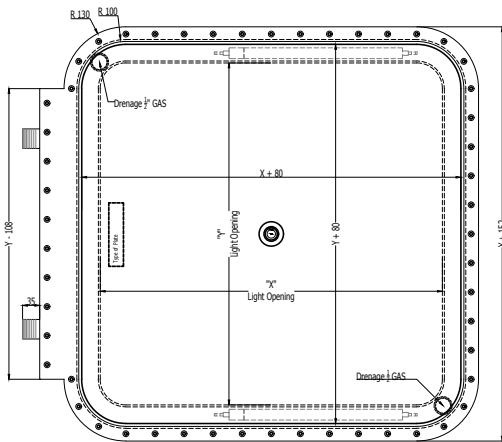
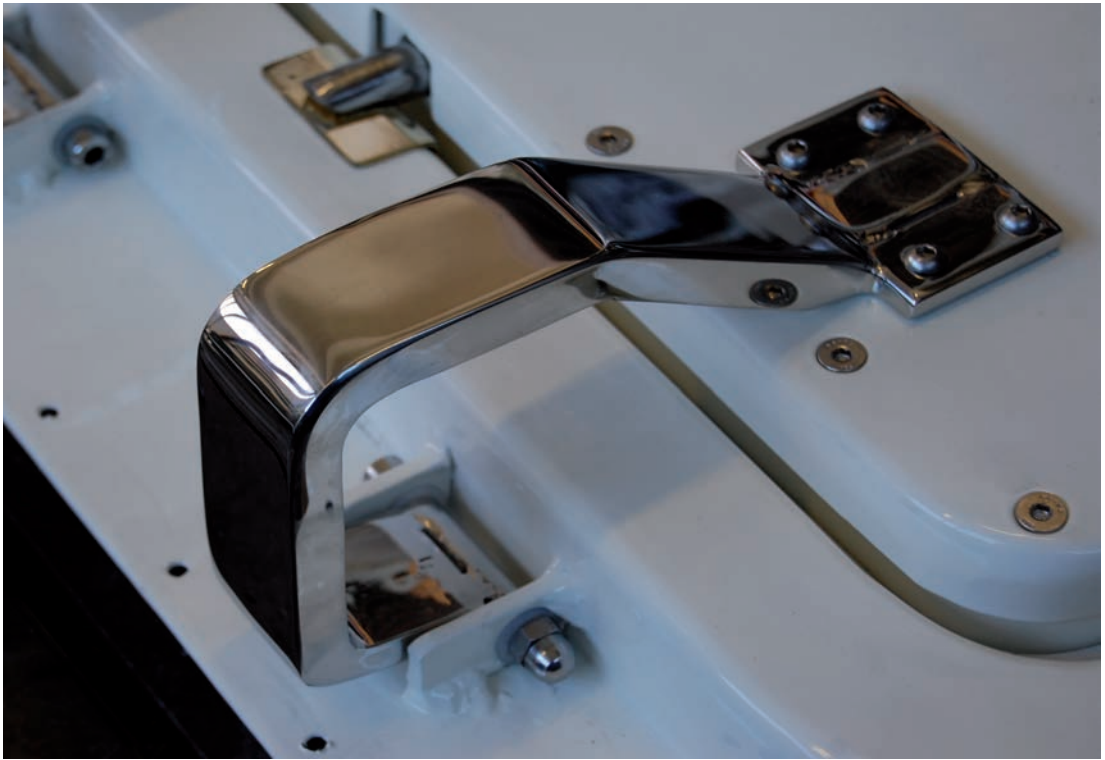

FLUSH

Caratteristiche standard

- Telaio in alluminio (Type approval) o acciaio inox (A30)
- 2 cerniere paiolo in inox
- Sensore chiuso/aperto
- Chiusura esterna in acciaio inox
- Maniglia interna in acciaio inox
- 5 spade di serraggio in acciaio inox diam 16
- 1 molla a gas

Opzioni

- Telaio verniciato
- 2 molle a gas
- Chiusura esterna con chiave
- Volantino interno in acciaio inox

Main features

- *Unpainted aluminum (Type approved) or stainless steel (A30)*
- *2 flash stainless steel hinges*
- *Open/close sensor*
- *External stainless steel closing system*
- *Internal stainless steel central toggle*
- *5 stainless steel dogs diam 16 mm*
- *1 gas spring*

Options

- *Frame painted in color on request*
- *2 gas spring*
- *External security key closing system*
- *Internal stainless steel wheel*



TYPE APPROVAL

A30

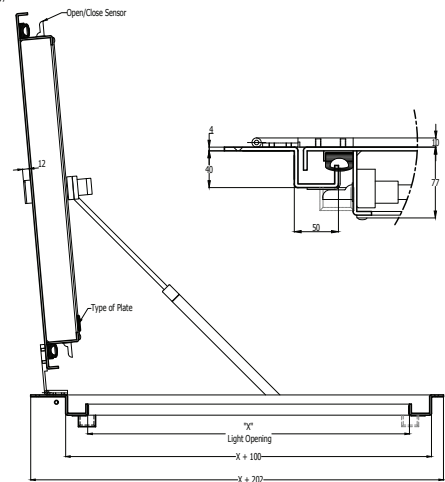
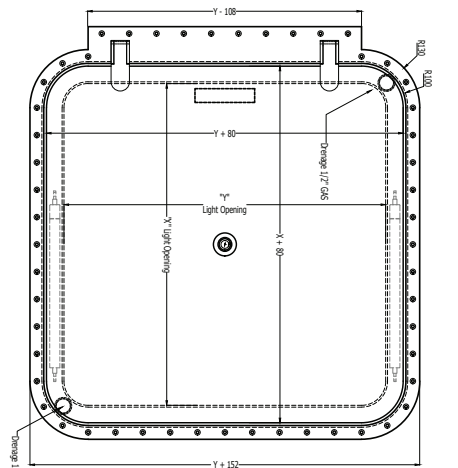

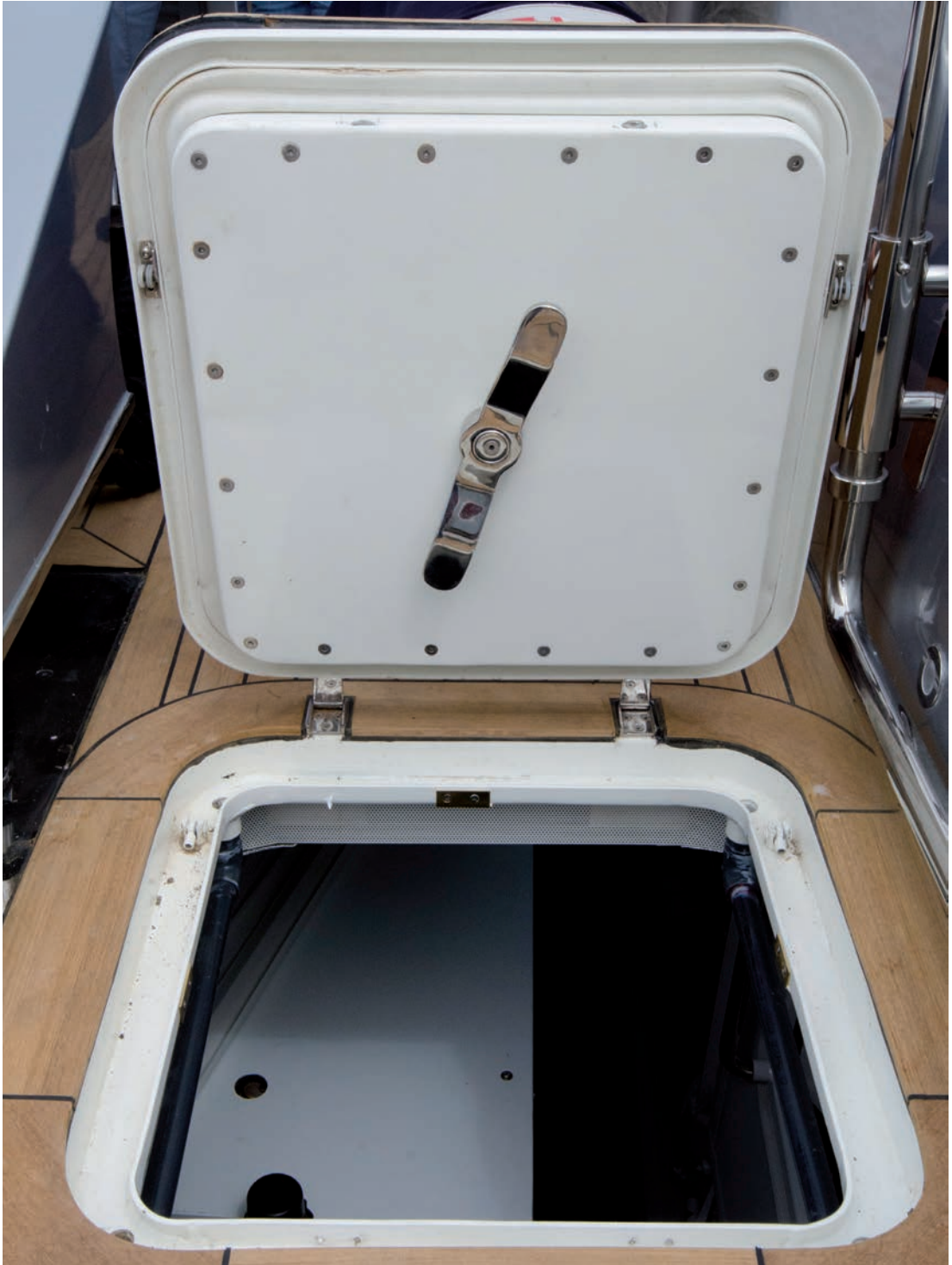

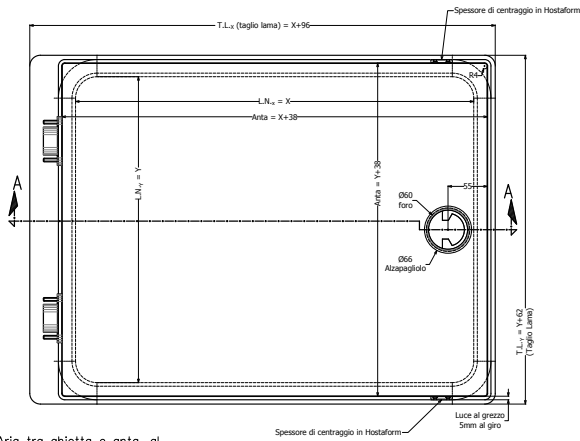

Aria tra ghiotta e anta, al grezzo, 5mm al giro

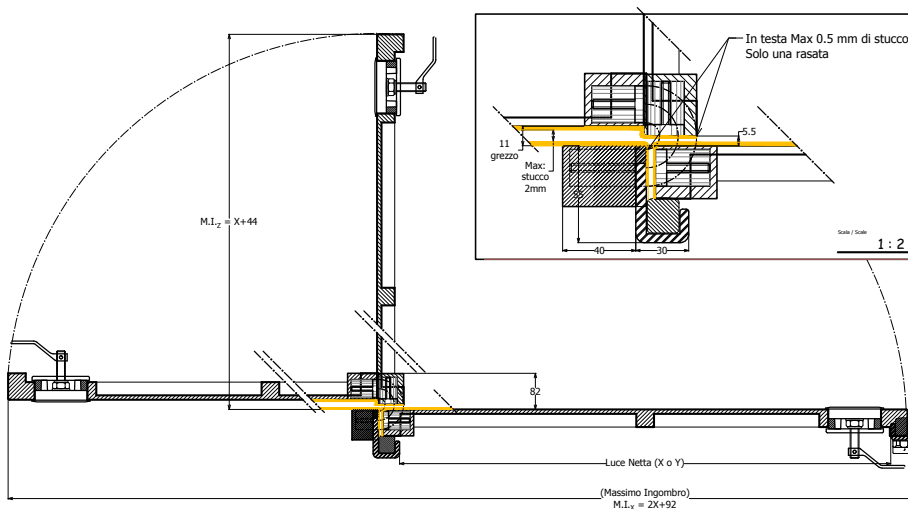



PORTE LATERALI INCERNIERATE
HINGED CORRIDOR DOORS

OCEAN

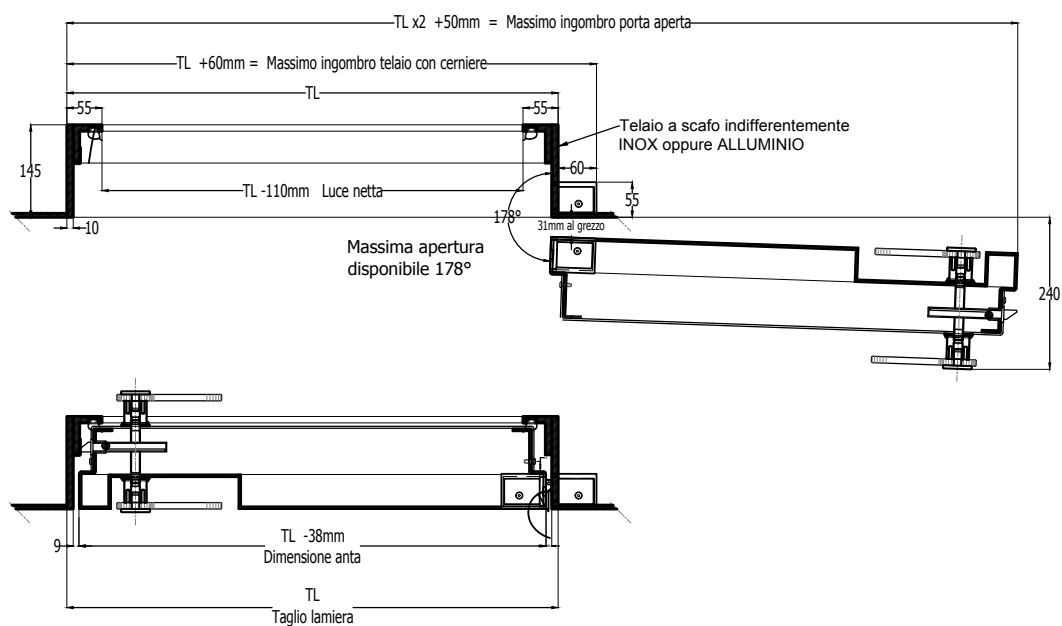

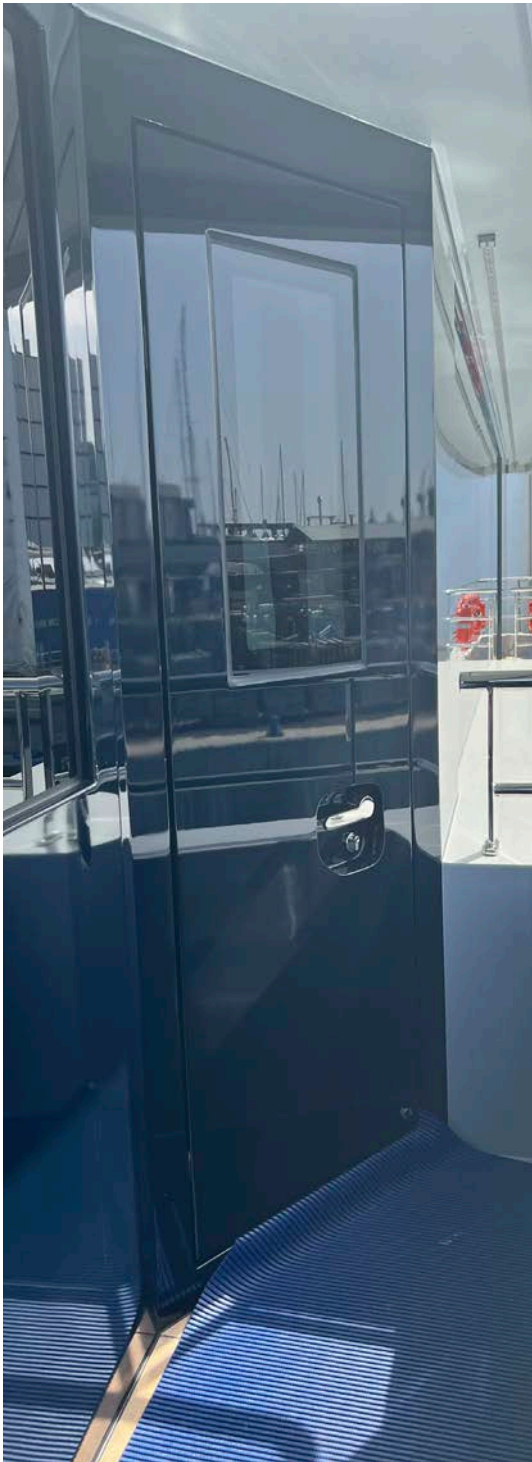

PORTE DI POPPA SCORREVOLI MANUALI
MANUAL SLIDING DOORS

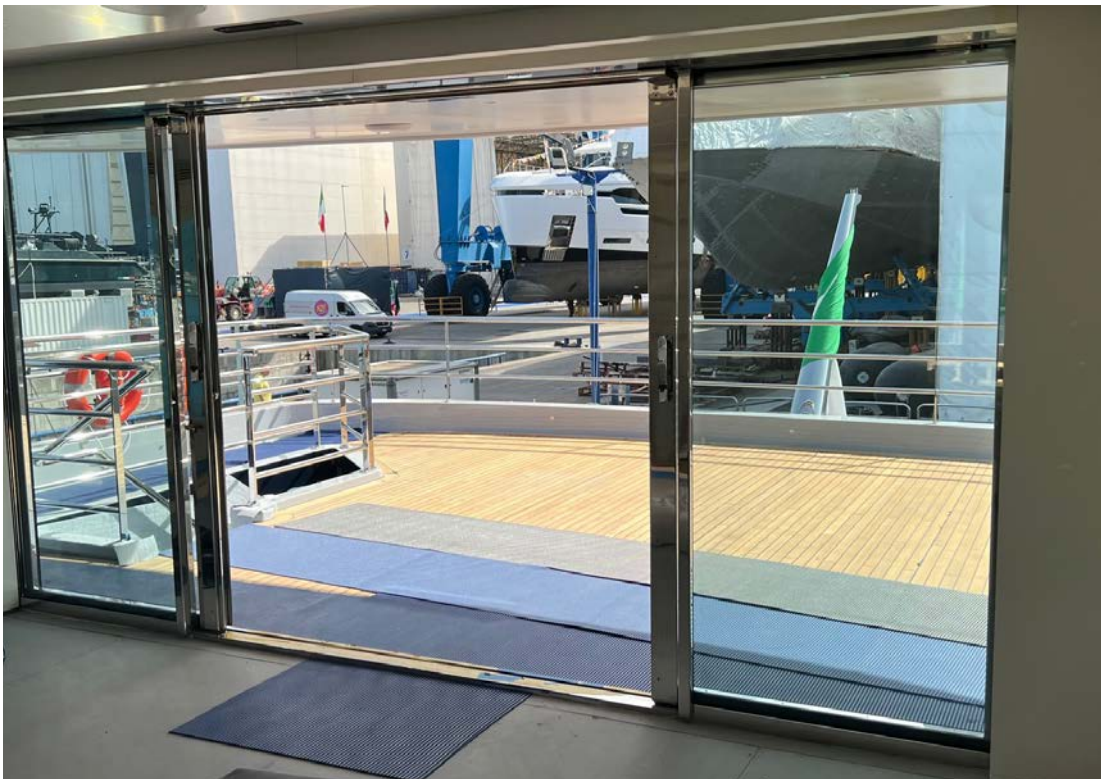





EC TYPE EXAMINATION (MODULE B)

CERTIFICATE No. MED016820CS

This is to certify that RINA Services S.p.A. (Notified Body No. 0474) did undertake the relevant type approval procedures for the equipment identified below, which was found to be in compliance with the Fire Protection requirements of Marine Equipment Directive (MED) 2014/90/EU, including the requirements and testing standards of Regulation (EU) 2019/1397.

MED Item N°	MED/3.16
Description	Fire doors
Type	FIRE RESISTANT A-30 CLASS SINGLE LEAF HINGED DOOR
Applicant	METALSTYLE SRL VIA STATALE S. PIETRO 23/B 16042 Carasco (GE) ITALY
Testing standards	IMO Res. MSC.61(67)-(FTP Code), IMO MSC/Circ.1120
Reference standards	Chap. II-2 of SOLAS 74 Convention, as amended, RINA Rules for the certification of Marine Equipment
Issued in Genoa on January 13, 2020	<i>This Certificate is valid until</i> January 11, 2025

This Certificate consists of this sheet plus an attachment

Enrico Cabella
RINA Services S.p.A.

This document is a copy of a digitally signed file available on Rina Web Site: <http://www.rina.org>



ATTACHMENT TO
CERTIFICATE No. MED016820CS

Page 1 of 2

Manufacturer
METALSTYLE SRL

Place of Manufacturer
VIA STATALE S. PIETRO 23/B
16042 Carasco (GE)
ITALY

Product description

Single leaf hinged door whose maximum clear opening size is 793 mm wide, 1927 mm high bolted, by means of bolts fitted with pitch of 55 mm, to a representative bulkhead of A Class. The door leaf, having maximum width of 819 mm, height of 1945 mm and thickness of 112.5 mm, is composed of a carbon steel plate 4 mm thick having the edges bended to the rabbet and of a carbon steel sheet 1 mm thick fitted in the opposite side. Between the two sheets is fitted the insulating material composed, moving from the carbon steel plate 4 mm thick side, of one layer of mineral wool type GEOLAN B-571 manufactured by Fibran S.A. having thickness of 50 mm and density of 175 kg/m^3 , a void space 47 mm deep and one layer of material named PROMAGUARD, 10 mm thick and having density of 240 kg/m^3 . The door frame is composed of a stainless steel profile, 4 mm thick, bolted to the bulkhead on the hinge side; the door is fitted with a stainless steel coaming, 109 mm deep and having thickness from 4 to 6 mm fitted on the side opposite to the hinges. The door is fitted with U shaped steel stiffeners installed as a lattice structure and welded to the steel plate having thickness of 4 mm. The door is equipped with a lever closing device, fitted inside the leaf, that acts on eight points and is actuated by an handwheel.

Field of application

Fire resistant A-30 Class single leaf door with fire hazard restricted to the hinge side.

Reference documents

Metallart drawing No. PT_1980x850_MO_002R3 Rev. 0 dated 10 August 2009 approved on 16 September 2009 with endorsement No. LABS-274 and drawing No. Porta_1980x850_AS 2_2R3 dated 16 December 2009 approved on 13 January 2010 with endorsement LABS-390.

Tests carried out

Tests as per RINA Test Laboratory Report No. 2009CS011935 issued on 13 January 2010 according to IMO Res. A. 754(18).

This certificate annuls and replaces the certificate No. MED070215CS dated 03/12/2015 due to renewal.

This document is a copy of a digitally signed file available on Rina Web Site: <http://www.rina.org>



CERTIFICATO DI OMOLOGAZIONE DI TIPO
TYPE APPROVAL CERTIFICATE
N. DIP217424CS/001

Si certifica che il seguente prodotto soddisfa le prescrizioni delle norme RINA per l'omologazione di tipo.
This is to certify that the product identified below is in compliance with the applicable requirements of the RINA type approval system.

Descrizione <i>Description</i>	Porta stagna <i>Watertight door</i>
Tipo <i>Type</i>	RANGE DI PORTE STAGNE Luce Netta 770 x 413 mm - 1980 x 850 mm WATERTIGHT DOORS RANGE Net Light 770 x 413 mm - 1980 x 850 mm
Fabbricante <i>Manufacturer</i>	METALSTYLE SRL
Luogo di produzione <i>Place of manufacture</i>	VIA STATALE SAN PIETRO 23 B 16122 CARASCO (GE)
Norme di riferimento <i>Reference standards</i>	Rules for the Classification of Yachts designed for Commercial Use, Rules for the Classification of Pleasure Yachts <i>Rules for the Classification of Yachts designed for Commercial Use, Rules for the Classification of Pleasure Yachts</i>

Rilasciato a **VIAREGGIO** il **24 Giugno 2024**.

Questo Certificato è valido fino al **16 Giugno 2027**

Issued in VIAREGGIO on June 24, 2024 . This Certificate is valid until June 16, 2027

Andrea Venturelli

RINA Services S.p.A.

Questo Certificato e' composto di 1 pagina e di 1 allegato
This certificate consists of this page and 1 enclosure



CERTIFICATO DI OMOLOGAZIONE DI TIPO
TYPE APPROVAL CERTIFICATE
N. DIP217424CS/001

Allegato - Pagina 1/1

Enclosure - Page 1 of 1

RANGE DI PORTE STAGNE Luce Netta 770 x 413 mm - 1980 x 850 mm , WATERTIGHT DOORS RANGE Net Light 770 x 413 mm - 1980 x 850 mm

Documenti di riferimento / Reference documents:

- Pratiche n° 2014/CS/01/125, 2017/CS/01/3830, 2021/CS/01/801, 2024/CS/01/2174 .
- Jobs nr. 2014/CS/01/125, 2017/CS/01/3830, 2021/CS/01/801, 2024/CS/01/2174.

Descrizione Prodotto / Product Description

- Porte stagne a battente: 1980 mm x 850 mm; 1420 mm x 620 mm; 770 mm x 700 mm; 1663 mm x 413 mm.
- Vedere disegni approvati con n.ri da DIP-47616 a DIP-47629, da DIP-47958 a DIP-47960, DIP-49578 e DIP-89326.
- Se vengono impiegati gli stessi materiali, come da disegni approvati, l'omologazione può essere considerata valida per tutte le dimensioni così descritte: lato corto compreso tra 413 e 850 mm e lato lungo compreso tra 770 e 1980 mm.
- Quando installate nei fianchi di una sovrastruttura, le porte devono essere incernierate sul loro lato prodiero.
- Dopo l'installazione a bordo, deve essere eseguita prova di spingardatura.
- L'omologazione è riferita alla sola "tenuta stagna a battente".
- Porte idonee per una battente di pressione idraulica pari a 4 m.
- Porte installate su percorsi di sfuggita:
 - unità uso privato: dovranno essere apribili da entrambi i lati senza l'uso di chiavi o utensili;
 - unità uso commerciale: dovranno essere apribili da entrambi i lati. Nella direzione di fuga dovranno essere apribili senza l'uso di chiavi. Le maniglie sul lato interno dovranno essere di tipo non rimovibile.
- *Watertight doors: 1980 mm x 850 mm; 1420 mm x 620 mm; 770 mm x 700 mm; 1663 mm x 413 mm.*
- *See drawings approved with nr. from DIP-47616 to DIP-47629, from DIP-47958 to DIP-47960, DIP-49578 and DIP-89326.*
- *If the same construction materials, as per approved a.m. drawing, will be used, the T.A. may be considered suitable for all the dimensions so that: short side between 413 and 850 mm and long side between 770 and 1980 mm.*
- *When located in houseside, the doors are to be hinged at the forward edge.*
- *After installation on board, a water jet test is to be carried out.*
- *The T.A. is relevant only to "watertightness".*
- *Doors suitable for an hydraulic pressure of 4 m head.*
- *Doors fitted on escape ways:*
 - private use yachts: they are to be openable from either sides without the use of keys or tools;*
 - commercial use yachts: they are to be openable from either side. In the direction of escape they are to be openable without a key. All handles on the inside hatches are to be non-removable.*
- Campi di applicazione: / *Fields of application:*
 - Porte stagne a battente per "RINA Rules for the Classification of Yachts designed for Commercial Use" e "RINA Rules for the Classification of Pleasure Yachts". / - *Watertight doors for "RINA Rules for the Classification of Yachts designed for Commercial Use" and "RINA Rules for the Classification of Pleasure Yachts".*

Note / Notes

- Il presente certificato annulla e sostituisce il cert. nr. DIP/217424CS.
- *This certificate annuls and replaces cert. nr. DIP/217424CS.*

VIAREGGIO24 Giugno 2024 VIAREGGIO June 24 2024

RINA Services S.p.A.
Via Corsica, 12 - 16128 Genova
Tel +39 010 53851
Fax +39 010 5351000

Digitally signed by RINA Services S.p.A. on 24 Jun 2024. No handwritten signature is provided.



TYPE APPROVAL CERTIFICATE
No. LAB067424CS/001

This is to certify that the product identified below is in compliance with the regulations herewith specified.

<i>Description</i>	Hatch fitted on deck
<i>Type</i>	FLUSH
<i>Applicant</i>	METALSTYLE SRL VIA STATALE S. PIETRO 23/B 16042 Carasco (GE) ITALY
<i>Manufacturer</i>	METALSTYLE SRL
<i>Place of manufacture</i>	VIA STATALE S. PIETRO 23/B 16042 Carasco (GE) ITALY
<i>Reference standards</i>	IMO Res. MSC.307(88)-(2010 FTP Code) - Part. 3
<i>Reference documents</i>	Chap. II-2 of SOLAS 74 Convention, as amended, RINA Rules for the Testing and Certification of Marine Materials and Equipment

Issued in **Genoa** on **May 10, 2024**. This Certificate is valid until **May 9, 2029**

This document is electronically signed by

Enrico Cabella

RINA Services S.p.A.

This Certificate annuls and replace the previous one No. LAB090319CS/002 issued on the 18/03/2019
This certificate consists of this page and 1 enclosure

TYPE APPROVAL CERTIFICATE

No. **LAB067424CS/001**

Enclosure - Page 1 of 1

FLUSH

Product description

Hatch having leaf dimensions up to 830 mm x 830 mm (clear opening up to 750mm x 750mm) and thickness of 76 mm, is composed, moving from the side exposed to the fire, of a pressformed box shaped 2 mm thick and of a stainless steel plate 4 mm thick. The two sheets are perimetally joined together by means of welded L profile having thickness of 4 mm and internally by means of 2 U stiffeners 50X30 mm welded on the stainless steel plate of 4 mm. Inside leaf an insulating material compound is fitted which is composed, moving from the side exposed to the fire, of one layer of non-combustible material type Promaguard 10 mm thick and one layer of mineral wool type GEOLAN B-571 manufactured by FIBRAN S.A. having thickness of 50 mm and density of 175 kg/m³. The hatch frame is composed of a steel profile 4 mm thick fixed to the deck by means of 34 steel screws type M6X30. The hatch opening system is secure by means of two hinges while the closure is made tight with a silicone gasket type Art-Inox dimensions of 30x20 mm fitted in the banded edge on the rabbet which is shielded with a thermo-expanding gasket type Promaseal LSK having dimensions of 15x2 mm fitted on the perimetral edge leaf and frame. The hatch is equipped with a wedge closing system inside leaf, that acts on 5 steel poles by means of one handle.

Field of application

Fire resistant A-30 Class hinged hatch single leaf in compliance with IMO MSC.1/Circ. 1319 dated 11 June 2009. In this case the dimensions relevant to the height and width of the door may be increased of 15% provided that the surface area is not increased of more than 10%.

Reference documents

METALLART drawing No. 8100-126-000-4 dated 27th February 2014 approved on 25 February 2014 with endorsement No. LABS-874.
METALSTYLE Srl drawing No. 8100-126-000-4 rev. 01 dated 19th April 2024. (product name change)

Tests carried out

Test as per RINA Test Laboratory report No. 2013CS013680 issued on 17 March 2014 according to Appendix 1 of IMO 2010 FTPC Part 3.

Remarks

Each item of the mass production to be fitted on vessels classed by RINA is to be previously inspected at the manufacturer workshop by a RINA Surveyor and is to be marked or labelled with the trade name and the data of the Company to whom this Certificate is addressed. The validity of this Certificate ceases in the case of amendments to the rules on the basis of which the Certificate was issued.

General conditions for the approval

- a) The initial conditions verified by RINA at the time of the approval are to be maintained, included the validity of the requested certificate of the single components (i.e. insulation materials)
- b) Any changes to the initial conditions are to be promptly communicated to RINA, which reserves the right to repeat the relevant assessment
- c) This certificate will no be valid if the manufacturer makes any changes or modifications to the approved equipment, which have not been notified to, and agreed with RINA
- d) RINA personnel are to be allowed to witness during the performances of activities, upon their request
- e) The activities are to be carried out in compliance with the RINA Rules and/or other applicable Rules
- f) Should the specified regulations or standards be amended during the validity of this certificate, the product is to be reapproved prior to it being placed on board vessels to which the amended regulations or standards apply.

Genoa May 10, 2024

File Allegato/Attached file



TYPE APPROVAL CERTIFICATE
No. **LAB067424CS/002**

This is to certify that the product identified below is in compliance with the regulations herewith specified.

<i>Description</i>	Hatch fitted on deck
<i>Type</i>	DUCK
<i>Applicant</i>	METALSTYLE SRL VIA STATALE S. PIETRO 23/B 16042 Carasco (GE) ITALY
<i>Manufacturer</i>	METALSTYLE SRL
<i>Place of manufacture</i>	VIA STATALE S. PIETRO 23/B 16042 Carasco (GE) ITALY
<i>Reference standards</i>	IMO Res. MSC.307(88)-(2010 FTP Code) - Part. 3
<i>Reference documents</i>	Chap. II-2 of SOLAS 74 Convention, as amended, RINA Rules for the Testing and Certification of Marine Materials and Equipment

Issued in **Genoa** on **May 10, 2024**. This Certificate is valid until **May 9, 2029**

This document is electronically signed by

Enrico Cabella

RINA Services S.p.A.

This Certificate annuls and replace the previous one No. LAB090319CS/001 issued on the 18/03/2019
This certificate consists of this page and 1 enclosure

TYPE APPROVAL CERTIFICATE

No. **LAB067424CS/002**

Enclosure - Page 1 of 1

DUCK

.Product description

Hatch, having leaf dimensions up to 830 mm x 830 mm and thickness of 76 mm, is composed, moving from the side exposed to the fire, of a preformed box shaped 2 mm thick, and of a stainless steel plate 4 mm thick. The two sheets are perimetally joined together by means of welded L profile having thickness of 4 mm and internally by means of 2 U stiffeners 50x30 mm welded on the stainless steel plate of 4 mm. Inside leaf an insulating material compound is fitted which is composed, moving from the side exposed to the fire, of one layer of non-combustible material type Promaguard 10 mm thick and one layer of mineral wool type GEOLAN B-571 manufactured by FIBRAN S.A. having thickness of 50 mm and density of 175 kg/m³. The hatch frame is composed of a steel profile 4 mm thick fixed to the deck by means of 34 steel screws type M6X30. The hatch opening system is secure by means of two goose neck hinges while the closure is made tight with a silicone gasket type Art-Inox dimensions of 30x20 mm fitted in the bended edge on the rabbet which is shielded with a thermo-expanding gasket type Promaseal LSK having dimensions of 15x2 mm fitted on the perimetral edge leaf and frame. The hatch is equipped with a wedge closing system inside leaf, that acts on 5 steel poles by means of one handle.

Field of application

Fire resistant A-30 Class hinged hatch single leaf fitted on deck with maximum dimensions of 830 mm x 830 mm. Fire resistant A-15 Class hinged hatch single leaf in compliance with IMO MSC.1/Circ. 1319 dated 11 June 2009. In this case the dimensions relevant to the height and with of the hatch may be increased of 15% provided that the surface area is not increased of more than 10%.

Reference documents

METALLART drawing No. 8100-116-000-4 dated 27 February 2014 approved on 25 February 2014 with endorsement No. LABS-875.
METALSTYLE Srl drawing No. 8100-116-000-4 rev. 01 dated 19th April 2024. (product name change)

Tests carried out

Test as per RINA Test Laboratory report No. 2013CS013680 issued on 17 March 2014 according to Appendix 1 of IMO 2010 FTPC Part 3.

General conditions for the approval

- a) The initial conditions verified by RINA at the time of the approval are to be maintained, included the validity of the requested certificate of the single components (i.e. insulation materials)
- b) Any changes to the initial conditions are to be promptly communicated to RINA, which reserves the right to repeat the relevant assessment
- c) This certificate will no be valid if the manufacturer makes any changes or modifications to the approved equipment, which have not been notified to, and agreed with RINA
- d) RINA personnel are to be allowed to witness during the performances of activities, upon their request
- e) The activities are to be carried out in compliance with the RINA Rules and/or other applicable Rules
- f) Should the specified regulations or standards be amended during the validity of this certificate, the product is to be reapproved prior to it being placed on board vessels to which the amended regulations or standards apply.

Genoa May 10, 2024

File Allegato/Attached file



CERTIFICATO DI OMOLOGAZIONE DI TIPO
TYPE APPROVAL CERTIFICATE
N. **DIP263024CS**

Si certifica che il seguente prodotto soddisfa le prescrizioni delle norme RINA per l'omologazione di tipo.
This is to certify that the product identified below is in compliance with the applicable requirements of the RINA type approval system.

Descrizione <i>Description</i>	Boccaportelli stagni <i>Watertight hatches</i>
Tipo <i>Type</i>	RANGE DI PORTELLI A PONTE Luce Netta 500 x 500 mm - 750 x 750 mm RANGE OF WATERTIGHT HATCHES Net Light 500 x 500 mm - 750 x 750 mm
Fabbricante <i>Manufacturer</i>	METALSTYLE SRL
Luogo di produzione <i>Place of manufacture</i>	VIA STATALE SAN PIETRO 23 B 16122 CARASCO (GE)
Norme di riferimento <i>Reference standards</i>	ITALY Rules for the Classification of Yachts designed for Commercial Use, Rules for the Classification of Pleasure Yachts <i>Rules for the Classification of Yachts designed for Commercial Use, Rules for the Classification of Pleasure Yachts</i>

Rilasciato a **VIAREGGIO** il **17 Giugno 2024**.
Questo Certificato è valido fino al **16 Giugno 2027**
Issued in VIAREGGIO on June 17, 2024 . This Certificate is valid until June 16, 2027

Andrea Venturelli
RINA Services S.p.A.

Questo Certificato e' composto di 1 pagina e di 1 allegato
This certificate consists of this page and 1 enclosure

RINA Services S.p.A.
Via Corsica, 12 - 16128 Genova
Tel +39 010 53851
Fax +39 010 5381000

Digitally signed by RINA Services S.p.A. on 17 Jun 2024. No handwritten signature is provided.



CERTIFICATO DI OMOLOGAZIONE DI TIPO
TYPE APPROVAL CERTIFICATE
N. DIP263024CS

Allegato - Pagina 1/1

Enclosure - Page 1 of 1

RANGE DI PORTELLI A PONTE Luce Netta 500 x 500 mm - 750 x 750 mm
RANGE OF WATERTIGHT HATCHES Net Light 500 x 500 mm - 750 x 750 mm

Documenti di riferimento:

- Pratiche n° 2014/CS/01/419, 2015/CS/01/491, 2017/CS/01/3832, 2021/CS/01/800, 2024/CS/01/2630.

Reference documents:

- Jobs nr. 2014/CS/01/419, 2015/CS/01/491, 2017/CS/01/3832, 2021/CS/01/800, 2024/CS/01/2630.

Descrizione Prodotto:

- Portelli stagni: dimensioni 500 x 500 mm, 750 x 750 mm.
- Vedere disegni approvati con n° DIP-70266, DIP-70267, DIP-70268, DIP-70269, DIP-70270 e DIP-70271 il 12/02/2014 e DIP-75061, DIP-75062 il 16/02/2015.
- Se vengono impiegati gli stessi materiali, come da disegni approvati, l'omologazione può essere considerata valida per tutte le dimensioni così descritte: lato corto compreso tra 500 e 750 mm e lato lungo compreso tra 500 e 750 mm.
- Dopo l'installazione a bordo, deve essere eseguita prova di spingardatura.
- L'omologazione è riferita alla sola "tenuta stagna a battente".
- Portelli idonei per un battente di pressione idraulica pari a 3 m.
- Portelli installati su percorsi di sfuggita:
 - unità uso privato: dovranno essere apribili da entrambi i lati senza l'uso di chiavi o utensili;
 - unità uso commerciale: dovranno essere apribili da entrambi i lati. Nella direzione di fuga dovranno essere apribili senza l'uso di chiavi. Le maniglie sul lato interno dovranno essere di tipo non rimovibile.

Product Description:

- *Watertight hatches: dimensions 500 x 500 mm, 750 x 750 mm.*
- *See drawings approved with nr. DIP-70266, DIP-70267, DIP-70268, DIP-70269, DIP-70270 and DIP-70271 on 12/02/2014 and DIP-75061, DIP-75062 on 16/02/2015.*
- *If the same construction materials, as per approved a.m. drawings, will be used, the T.A. may be considered suitable for all the dimensions so that: short side between 500 and 750 mm and long side between 500 and 750 mm.*
- *After installation on board, a water jet test is to be carried out.*
- *The T.A. is relevant only to "watertightness".*
- *Hatches suitable for an hydraulic pressure of 3 m head.*
- *Hatches fitted on escape ways:*
 - private use yachts: they are to be openable from either sides without the use of keys or tools;*
 - commercial use yachts: they are to be openable from either side. In the direction of escape they are to be openable without a key. All handles on the inside hatches are to be non-removable.*

Campi di applicazione:

- Portelli stagni a battente per "RINA Rules for the Classification of Yachts designed for Commercial Use" e "RINA Rules for the Classification of Pleasure Yachts".

Fields of application:

- *Watertight hatches for "RINA Rules for the Classification of Yachts designed for Commercial Use" and "RINA Rules for the Classification of Pleasure Yachts".*

VIAREGGIO 17 Giugno 2024

VIAREGGIO June 17, 2024

RINA Services S.p.A.
Via Corsica, 12 - 16128 Genova
Tel +39 010 53851
Fax +39 010 5351000

Digitally signed by RINA Services S.p.A. on 17 Jun 2024. No handwritten signature is provided.



Head Office & Factory

Via Statale San Pietro, 23 B - 16042 Carasco (GE) Italy

Ph +39 0185 350345 - Fax +39 0185 1831149

www.metalstyle.com